

KYE - Corporate



**Know Your EXIT™**  
Health & Safety Compliance Systems



## KYE - Corporate *welcome*



### **How much do Fire Drills cost your business?**

In the event of an emergency situation, does every single employee know what to do? Is that essential information being delivered directly and is it being absorbed?

According to NISO – the National Irish Safety Organisation, it can cost the average manufacturing industry of approximately 300 people between 12,000 euro and 15,000 euro per fire drill in downtime AND loss of production.

With Fire Exits and vital Health and Safety Equipment potentially blending into the background there needs to be a system that keeps that information fresh in the minds of every single employee. It is time to bring the emergency evacuation to the desktop with Know Your Exit.

Know Your Exit is the virtual evacuation system that is directed at every employee in your building at any time. The system pinpoints the exact location of all emergency equipment relevant to each individual and specifically maps out their primary and secondary escape routes.

By delivering this key Health & Safety information to the Desktop you can;

- Reduce Downtime and save Valuable Budgets
- Streamline Evacuations using Virtual Fire Drills
- Enhance In-House Training Procedures

Ensuring that everyone knows how to react in an emergency situation, you can significantly reduce the cost of emergency planning and evacuation.

# KYE - Corporate *features*



Know Your Exit is a personalised evacuation awareness and management system designed and aimed at the employer and employee to train and educate on fire and safety issues within their environment. The system also maps out a personal evacuation plan for every individual in the company or institution.

With a rich and interactive graphical interface, the employee uses the system to up-skill on all Fire and Health & Safety issues within their workspace. From the location of Fire Exits and Extinguishers to First Aid Boxes, Fire Wardens and Defibrillators, Know Your Exit: Corporate can reduce the possibility of serious or fatal accidents in the workplace and increase awareness and speed of evacuation. Know Your Exit reduces potential evacuation times thus increasing revenue, giving you an immediate return on investment.

## Primary Escape Route indicator



## Integrated E-Learning Module

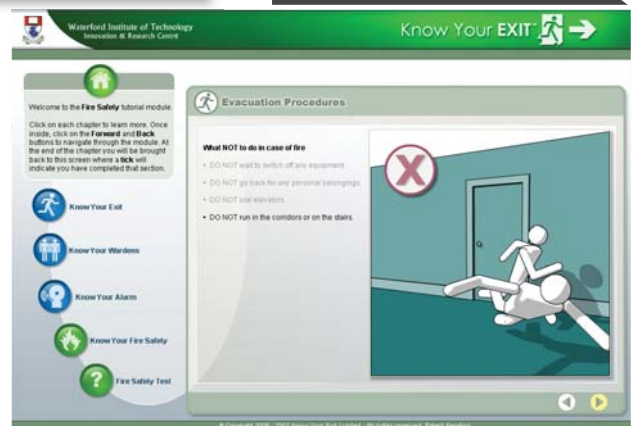

## KYE - Corporate *features*



Know Your Exit has a number of features that are expandable and customisable.

- **Fire Extinguisher/Fire Exit/Break Glass Units/Hose Reel locator**  
These locations are personally available at the click of a button in a graphically rich, easy-to-locate environment.
- **Medical Point Location**  
Indicates the locations of First Aid Kits and Emergency Defibrillators.
- **Employee Tracking and Examination Tool**  
Know Your Exit is an e-learning induction for new employees and for refresher training. This educates all employees and ensures they are all complying with company safety policies and red flags any anomalies to management.
- **Fire Alarm Sample - to ease confusion of multiple alarm sounds**  
It is important to differentiate between alarm sounds in an emergency situation. Know Your Exit uses a sample of the building structure fire alarm system that is available to listen to "strictly" with headphones.
- **Highlight Flammable Areas located within structure - Hotspots**  
A particular requirement in manufacturing or related industries to provide indicators of areas which are of higher risk or highly flammable.
- **Locator and Email facilities to Fire and Safety Wardens**  
Users can see who their Fire and Safety Wardens are, their location and contact details. This gives transparency to communicate on all Health and Safety issues at the click of a mouse regarding blocked exits, missing equipment or general Health and Safety queries.
- **Eye Wash/Shower/Drench Hose locator**  
The ease of customization in Know Your Exit means the integration of Emergency Shower, Eye Wash Units and Drench Hose locations on a building per building basis.
- **Customised Organisation-Specific E-Learning**  
Health and Safety content can be integrated into Know Your Exit including customised e-learning content that is specific and relevant to the building or the organisation. For example - Best Practices, Ergonomics, Management Skills.
- **Ability to customise to incorporate company logos/banners/themes**  
The system can be edited to incorporate company specific logos and themes.

# KYE - Corporate *the benefits*



KYE - Corporate Features	Benefits to Client
<b>Know Your Exit Personalised Escape Routes</b>	Avoiding the “Lemming Effect” where everyone follows each other whether the route is right or wrong.
<b>Know Your Exit Find All mode</b>	Individuals become familiar with the FULL location of Life Saving Equipment throughout the building.
<b>Know Your Exit Find My mode</b>	Individuals become familiar with the immediate location of Life Saving Equipment.
<b>Know Your Alarm</b>	Recognising the Fire Alarm is now an inexcusable part of the Emergency Evacuation Procedure.
<b>Know Your Wardens</b>	Transparent Communication with Fire Wardens and First Aid Officers with any Health & Safety Issues such as blocked Fire Exits or missing Equipment.
<b>Know Your Fire Safety</b>	Emergency Procedures brought to life using full 3D animation. Ideal for Induction and Refresher Training.
<b>Fire Safety Test</b>	Testing all employees not only on their generic Health & Safety procedures, but on their specific building ensuring full knowledge of their surroundings.

GIVING COMPANIES THAT KNOWLEDGE POWER TO ALL EMPLOYEES OF THEIR “BUILDING SPECIFIC” HEALTH AND SAFETY PROCEDURES, AS A RESULT STREAMLINING EMERGENCY EVACUATIONS AND REDUCING POTENTIAL RISKS OF CLAIMS .

# KYE - Corporate

FAQ



- 1. Is it expensive to set up? - As with every building, graphics and floor plans would be different. We are open plan, is this a problem?**

No, the Evacuation Management System is designed in a way that it can be tailored to suit the level of interactivity you require. The best starting point is to showcase the product, take a look at the plant and agree on an action plan that suits your budget.

We import standard CAD drawings of the building and strip each floor down to create a more user-friendly drawing that is easily read. With previous open plan office designs, we did a quick site visit and determined the layout based on a walkabout of each floor (if no partition drawings were available). If there are privacy issues, we naturally sign an NDA and can visit the site at a time that would minimise disruption.

- 2. Could be part of annual training for all staff?**

Absolutely, with this system in place, you can build on your own library of content that is always available. You can notify employees to log into the system and up-skill themselves on specific Health and Safety procedures based on the company's requirements. i.e. - Fire Evacuation Management, Communications, Handling Hazardous Materials etc.

- 3. Can we identify and/or notify H+S team members per floor?**

There is a section called 'Know Your Fire Wardens' that details Wardens and First Aid Officers specific to the building. Individuals can be contacted directly if there are any Health and Safety issues that need to be resolved.

- 4. Could it replace an actual fire drill?**

The system is designed to streamline evacuation procedures and to put the onus of safety back on the individual. Within large building structures, company induction methods tend to briefly discuss evacuation procedures with no specific training given. Most legislative signage fades into the background and the map on the back of the door largely goes unnoticed. In an emergency situation, most people tend to follow the crowd, whether their route is right or wrong.

Know Your Exit gives every individual in their specific building the quickest and most efficient escape route. The system compliments the fire drill and hammers home the message making a fire drill actually worth while. This reduces downtime, therefore, increasing productivity.

# KYE - Corporate *pricing*



Below is a breakdown of KYE - Corporate and its pricing structure.

description	price
<p><b>Know Your Exit System Installation</b></p> <ul style="list-style-type: none"> <li>• Know Your Exit Initial Development Costs</li> </ul>	<p><b>2400 EURO</b></p>
<p><b>Base Building Size</b></p> <p>The overall size of the building structure as described in Architectural CAD drawings including interactive locations (where applicable) of;</p> <ul style="list-style-type: none"> <li>• Fire Exits</li> <li>• Fire Extinguishers</li> <li>• Break-glass Units</li> <li>• First Aid Boxes/Defibrillator</li> <li>• Chemical Showers/Drench Hoses</li> <li>• Primary and Secondary Escape Routes</li> <li>• Assembly Points</li> <li>• Fire Warden/First Aid Officer locations</li> <li>• Emergency Alarm</li> <li>• Safety Procedures and Guidelines</li> <li>• 10 Generic H&amp;S Questions for Fire Safety Quiz</li> <li>• 10 Building Specific H&amp;S Questions for Fire Safety Quiz</li> </ul>	
<p><b>Individual Space</b></p> <p>Individual spaces are designed together with the base building development. This includes a breakdown into Office Spaces, Partitioned Sections, Canteens, Meeting Rooms and all other areas that will need an escape route from.</p> <p style="text-align: right;"><b>0.50 CENT - 1.00 EURO PER SQ. METRE*</b></p> <p style="text-align: right;"><i>* volume discounts apply</i></p>	

For more information on KYE - Corporate and Volume Discounts email us - [info@knowyourexit.com](mailto:info@knowyourexit.com).

# KYE - Corporate *service*



There are a number of areas that may need to be updated due to client-specific requests. With optional quarterly update visits either remotely or on-site, your Know Your Exit system can be kept up-to-date on all areas including;

## **Know Your Exit Section**

- Fire Exits
- Fire Extinguishers
- Showers/Eye Wash/Drench Hose
- Break-glass Units
- First Aid Boxes
- Defibrillators
- Primary and Secondary Escape Routes
- Internal Building Layout Change
- Assembly Points

## **Fire Warden/First Aid Officer Section**

- New Wardens/First Aid Officers added or removed
- Changes to Phone Nos., Email Addresses or Locations

## **Know Your Alarm Section**

- Changes or additions of new Emergency Alarm Warnings – e.g. specific machine alarm sounds

## **Fire Safety E-learning Section**

- Change of Safety Procedures within a company – e.g. Update of Health and Safety Guidelines

## **Fire Safety Test**

- Updating of new questions for employees – e.g. merging of office spaces, removal of Fire Equipment, Exits or Assembly Points

## **Know Your Exit: Service and Maintenance Agreement Pricing**

Optional Annual Service & Maintenance Agreement is priced per hour of maintenance.  
(excluding VAT)

**80 EURO PER HOUR**

# Know Your Exit

*location*



Know Your Exit is located in ArcLabs Research and Innovation Centre in Carriganore, Waterford. ArcLabs was established by Waterford Institute of Technology in 2005 and is based at the 150-acre West Campus in Carriganore in a woodland setting on the banks of the River Suir, just a few minutes from the outer ring road. This magnificent setting helps ArcLabs' companies to attract customers, staff and investment.

ArcLabs is the base for WIT's Centre for Entrepreneurship which promotes, supports and develops entrepreneurship programmes and research. The Centre delivers the South East Enterprise Platform Programme (SEEPP) which supports entrepreneurs involved in knowledge-based start-ups.

The centre is also the headquarters of one of Ireland's largest and most successful technology research operations, TSSG, which employs over 120 highly skilled researchers and developers and has attracted over 40 million in research programmes since its inception in 1996.

Contact Address	Contact Email	Contact Phone
<b>Know Your Exit Limited</b>	<b>info@knowyourexit.com</b>	<b>+353 51 302172</b>
ArcLabs Research & Innovation Centre	<b>sales@knowyourexit.com</b>	<b>+353 51 302173</b>
Carriganore	<b>support@knowyourexit.com</b>	
Waterford		
Ireland		

Registered in Ireland - No. 435752 VAT Reg. No. - IE 9654194S